



is a small tandem vibratory roller with an articulated frame and two smooth drums with a finished surface. Both drums are driven and vibrating. Vibration sources are one stage non-rectified vibration exciters placed in the drum axis. The drive of all machine functions is hydrostatical. The machine is equipped with Kubota engine, hydraulic Hydromatic-Rexroth. It fulfils the requirements of pollutants emission directives EPA/CARB Tier 1. It meets the CE marking conditions.

STANDARD

VH 170 / VH 180

- Operator platform without cabin with rails
- Lockable bonnet
- Lockable vandal guard
- Suspended operator's platform
- Forwards/backwards adjustable seat
- Seat with contact switch
- Both drums vibrating
- Transport lashing and lifting eyes front, rear
- Two scrapers per drum
- Plastic water tank
- One mode vibrators
- Operator can switch off/on a front/rear vibration
- Articulated frame
- Pre selection of the travel and vibration
- Vibration control in travel lever
- Both drums are hydrostatically driven
- Painting STA: yellow, grey

OPTIONS

VH 170 / VH 180

- ROPS protection (obligatory for CE)
- ROPS canopy (mounted to ROPS)
- Beacon
- Back up alarm
- Special painting

MAXIMAL COMPACTED LIFT THICKNESS AT OPTIMAL WORKING CONDITIONS (m)

	Asphalt	Sand/Gravel	Mixed soils	Silt	Clay	Stabilization
VH 170	0,10 m	0,15 m	0,10 m	-	-	0,10 m
VH 180	0,10 m	0,15 m	0,10 m	-	-	0,10 m

size (mm)	A	D	G	H	H1	H2	L	T	W	W1	W2
VH 170	1400	620	250	2560	1640	500	2050	11,5	900	986	43
VH 180	1400	620	250	2560	1640	500	2050	11,5	1000	1086	43

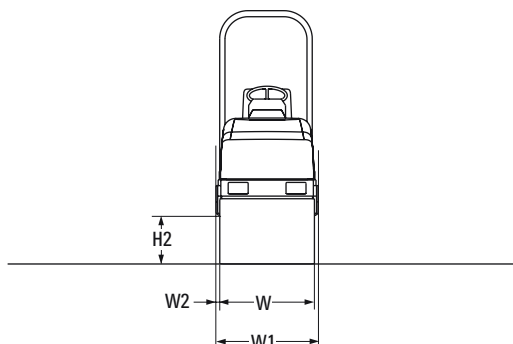
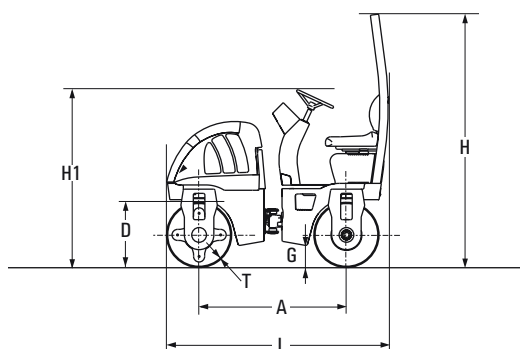

CAPACITY	VH 170	VH 180
Operating weight (CECE)	1728 kg	1807 kg
Compacting width maximum	900 mm	1000 mm
Drum offset	0 mm	0 mm

WEIGHTS	VH 170	VH 180
Operating weight maximum	1800 kg	1879 kg
Front drum load (CECE)	864 kg	903 kg
Rear drum load CECE	864 kg	904 kg
Front drum linear load	9,6 kg/cm	9,03 kg/cm
Rear drum linear load	9,6 kg/cm	9,04 kg/cm

STEERING	VH 170	VH 180
Steering angle (+ -)	35 deg	35 deg
Oscillation angle (+ -)	10 deg	10 deg
Turning radius inner (edge)	1770 mm	1720 mm
Turning radius outer (contour)	2710 mm	2760 mm

RIDING CHARACTERISTIC	VH 170	VH 180
No. of travel speeds	1	1
Maximal speed	10 km/h	10 km/h
Gradeability without vibration	40%	40%
Gradeability with vibration	32%	32%

VIBRATION	VH 170	VH 180
Amplitudes	0,4 mm	0,4 mm
Frequencies	60 Hz	60 Hz
Centrifugal forces	15 kN	15 kN

TANKS	VH 170	VH 180
Fuel	30 lt	30 lt
Watering water	100 lt	100 lt

ELEKTROINSTALLATION	VH 170	VH 180
Voltage	12 V	12 V

ENGINE	VH 170	VH 180
Make	Kubota	Kubota
Type	D722-EBB-EC	D722-EBB-EC
Rated power	14 kW	14 kW

Technical modifications and data reserved. Machines may be shown with options.

