



VH 300 and VH 350 are small tandem vibratory rollers with an articulated frame and two smooth drums with a finished surface. Both drums are driven and vibrating. VH 250 K is a combined vibratory roller with an articulated frame. The front axle consists of a smooth vibratory drum with a machined surface, the rear axle is fitted with four rubber-tired compaction wheels with a smooth tread. Both axles are driven. Vibration sources are one stage non-rectified vibration exciters placed in the drum axis. The drive of all machine functions is hydrostatical. The machine is equipped with Deutz engine, hydraulic Hydromatic-Rexroth. It fulfils the requirements of pollutants emission directives 97/68/ECE Stage 2 and EPA/CARB Tier 1. It meets the CE marking conditions.

STANDARD

VH 300 / VH 300 K / VH 350

- Operator platform without cabin with rails
- Lockable bonnet
- Lockable vandal guard
- Suspended operator's platform
- Forwards/backwards adjustable seat
- Slideable seat
- Seat with contact switch (for CE conformity)
- Both drums (drum) vibrating
- Transport lashing and lifting eyes front, rear
- Two scrapers per drum
- Plastic water tank
- One mode vibrators
- Operator can switch off/on a front/rear vibration
- Articulated frame
- Pre selection of the travel and vibration
- Vibration control in travel lever
- Both axes are hydrostatically driven
- Working halogen headlights
- Painting STA: yellow, grey

OPTIONS

VH 300 / VH 300 K / VH 350

- Diff lock
- ROPS protection (obligatory for CE)
- ROPS protection foldable
- ROPS canopy (mounted to ROPS)
- Beacon
- Back up alarm

MAXIMAL COMPACTED LIFT THICKNESS AT OPTIMAL WORKING CONDITIONS (m)

	Asphalt	Sand/Gravel	Mixed soils	Silt	Clay	Stabilization
VH 300	0,12 m	0,30 m	0,20 m	-	-	0,15 m
VH 300 K	0,10 m	0,25 m	0,20 m	-	-	0,10 m
VH 350	0,12 m	0,30 m	0,20 m	-	-	0,15 m



STAVOSTROJ, a.s.
 Náchodská 145, 549 01 Nové Město nad Metují, Czech Republic
 phone: +420 491 476 111
 fax: +420 491 470 215, 491 470 405
 e-mail: stavo@sta.cz, stasales@sta.cz, www.sta.cz

CERTIFICATED:
ISO 9001

VH 300, VH 350 VH 300 K



TANDEM & COMBINED ROLLERS (3.0 - 3.5 t)

size (mm)	A	D	G	H	H1	H2	L	T	W	W1	W2
VH 300	1715	738	310	2560	1825	610	2640	13	1200	1296	45
VH 300 K	1715	740	310	2560	1825	610	2640	13	1200	1296	45
VH 350	1715	746	310	2560	1825	612	2640	16	1300	1396	45

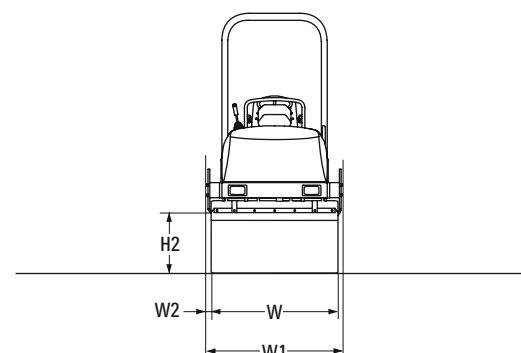
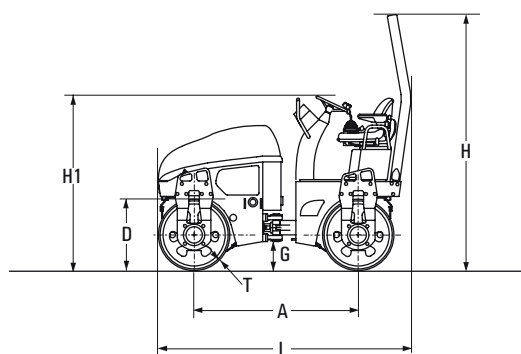

CAPACITY	VH 300	VH 300 K	VH 350
Operating weight (CECE)	3055 kg	3000 kg	3335 kg
Compacting width maximum	1200 mm	1200 mm	1300 mm
Drum offset	0 mm	0 mm	0 mm

WEIGHTS	VH 300	VH 300 K	VH 350
Operating weight maximum	3200 kg	3145 kg	3480 kg
Front drum load (CECE)	1520 kg	1500 kg	1660 kg
Rear axle load (CECE)		1500 kg	
Rear drum load (CECE)	1535 kg		1675 kg
Front drum linear load	12,7 kg/cm	12,7 kg/cm	12,8 kg/cm
Rear drum linear load	12,8 kg/cm		12,9 kg/cm

STEERING	VH 300	VH 300 K	VH 350
Steering angle (+ -)	33 deg	33 deg	33 deg
Oscillation angle (+ -)	10 deg	10 deg	10 deg
Turning radius inner (edge)	2300 mm	2300 mm	2250 mm
Turning radius outer (contour)	3550 mm	3550 mm	3600 mm
Transversal stability - straight	30 deg	30 deg	30 deg

RINDING CHARACTERISTIC	VH 300	VH 300 K	VH 350
No. of travel speeds	1	1	1
Maximal speed	10 km/h	10 km/h	10 km/h
Gradeability without vibration	30 %	30 %	30 %
Gradeability with vibration	33 %		33 %

BRAKES	VH 300	VH 300 K	VH 350
Operation	Hydrostatic	Hydrostatic	Hydrostatic
Parking	Multi disc	Multi disc	Multi disc
Emergency	Multi disc	Multi disc	Multi disc

VIBRATION	VH 300	VH 300 K	VH 350
Amplitudes	0,47 kN	0,47 kN	0,45 kN
Frequencies	53 / 62 Hz	53 / 62 Hz	53 / 62 Hz
Centrifugal forces	25,5 / 34,9 kN	25,5 / 34,9 kN	29,4 / 40,3 kN

WATERING	VH 300	VH 300 K	VH 350
Watering	Pressure	Pressure	Pressure
No. of pumps	1	1	1
Water filtration stages	2	2	2

TANKS	VH 300	VH 300 K	VH 350
Fuel	72 lt	72 lt	72 lt
Watering water	227 lt	227 lt	227 lt

ELEKTROINSTALLATION	VH 300	VH 300 K	VH 350
Voltage	12 V	12 V	12 V
Capacity of batteries	72 Ah	72 Ah	72 Ah

ENGINE	VH 300	VH 300 K	VH 350
Make	Deutz	Deutz	Deutz
Type	F3L1011F	F3L1011F	F3L1011F
Rated power	27,5 kW	27,5 kW	27,5 kW

Technical modifications and data reserved. Machines may be shown with options.



STAVOSTROJ, a.s.
 Náchodská 145, 549 01 Nové Město nad Metují, Czech Republic
 phone: +420 491 476 111
 fax: +420 491 470 215, 491 470 405
 e-mail: stavo@sta.cz, stasales@sta.cz, www.sta.cz

CERTIFICATED:
ISO 9001

