



is a new generation vibratory roller with the high comfort for an operator, up-to-date design with the "1 x 1 m" visibility and with an extremely low gravity centre. Outstanding traction force enables enduring operation of the roller under hardest conditions and in slopes 30% and more. VV 1500 D H is designed for medium and large scale compaction of rockfill, loose, semi-cohesive materials and stabilization. The machine is based on an articulated frame with a hydrostatic drive system of a smooth vibratory drum and two rubber tyred wheels. VV 1500 PD H is designed for medium and large scale compaction of semi-cohesive and cohesive materials. The machine is based on an articulated frame with a hydrostatic drive system of a padded vibratory drum and two rubber tyred wheels. Direct drive of the rear wheels through the hydromotors with gearboxes enables a very low built in mounting of the driving power unit, by keeping the minimal length of the machine. It offers to the user the advantage of an excellent view from the operator's place and excellent machine stability and manoeuvrability in comparison with the other machines, which are equipped with the rigid driving axles. The vibration source is a double staged undirected vibration exciter, placed in the centre of the drum. The machine is equipped with a hydrostatic drive of all machine functions, Cummins engine, hydraulic Sauer-Danfoss. It fulfils the requirements of pollutants emission directives 97/68/ECE Stage 2 and EPA/CARB Tier 2. The machine meets the CE marking conditions. **Blade version available.**

## STANDARD

### VV 1500 D H / VV 1500 PD H

- Cabin ventilated and heated
- Two mode vibrator
- Articulated frame
- Heavy duty travel hydrostatic transmission
- Interaxle and interwheel ASC differential lock
- Working halogen headlights
- Hand-pump hood and cabin tilting
- Tyres 23,1-26 tread R1 (TD-01) (10 PR)
- Tyres ballast liquid filling to -25 centigrades
- Painting STA: yellow, grey

## OPTIONS

### VV 1500 D H / VV 1500 PD H

- Operator platform without cabin with rails
- Lockable vandal guard
- Engine CUMMINS 6BT5.9-C148 (110 kW) - Stage 1/Tier 1
- Dozing blade
- Electrohydraulic cabin and hood tilting
- Engine air pre-cleaner for extra hard conditions
- ROPS protection (obligatory for CE)
- Cabin FOPS protection
- ROPS canvas canopy (mounted to ROPS)
- FOPS sun roof (mounted to ROPS)
- Air conditioning
- Tyres 23,1-26 tread UK 5 (10 PR) instead of standard ones
- Compaction indicator
- Compaction indicator printer
- Alternator safety screen
- Fan safety screen
- Turn indicators
- Beacon
- Back up alarm
- Engine speed indicator
- Special painting

### VV 1500 D H

- Segment kit 150 pads

## MAXIMAL COMPACTED LIFT THICKNESS AT OPTIMAL WORKING CONDITIONS (m)

	Rockfill	Sand/Gravel	Mixed soils	Silt	Clay	Stabilization
VV 1500 D H	1,20 m	0,80 m	0,70 m	0,50 m	0,30 m	-
VV 1500 PD H	-	-	0,70 m	0,50 m	0,35 m	-



**STAVOSTROJ, a.s.**  
 Náhodská 145, 549 01 Nové Město nad Metují, Czech Republic  
 phone: +420 491 476 111  
 fax: +420 491 470 215, 491 470 405  
 e-mail: stavo@sta.cz, stasales@sta.cz, www.sta.cz

CERTIFICATED:  
**ISO 9001**

# VV 1500 D H VV 1500 PD H



SINGLE DRUM ROLLERS - SMOOTH & PADDED (15 t)

size (mm)	A	D	D1	G	G1	H	H1	L	T	W	W1	W2
<b>VV 1500 D H</b>	2820	1500		420	430	3030	2375	5686	40	2200	2500	142
<b>VV 1500 PD H</b>	2820	1440	1640	420	430	3030	2375	5686	28	2200	2500	142

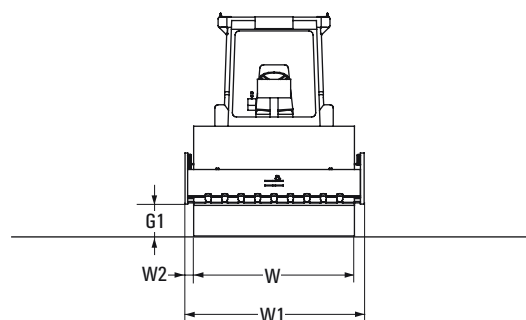
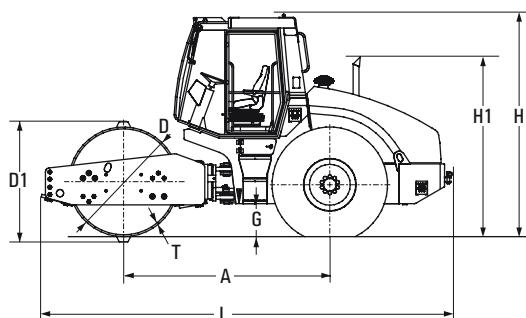

## CAPACITY

	VV 1500 D H	VV 1500 PD H
Operating weight (CECE)	15615 kg	15525 kg

## WEIGHTS

Operating weight maximum	15785 kg	15695 kg
Drum load (CECE)	10235 kg	10145 kg
Axle load (CECE)	5380 kg	5380 kg
Static linear load	46,5 kg/cm	

## DRUM

No. of pad feet		140
Height of pad		100 mm
Contact area of one pad foot		120 cm <sup>2</sup>

## STEERING

Steering angle (+ -)	36 deg	36 deg
Oscillation angle (+ -)	10 deg	10 deg
Turning radius inner (edge)	3050 mm	3050 mm
Turning radius outer (contour)	5395 mm	5395 mm
Transversal stability - straight	37 deg	37 deg

## RIDING CHARACTERISTIC

No. of travel speeds	4	4
Maximal speed	7 km/h	7 km/h
Gradeability without vibration	60 %	60 %
Gradeability with vibration	60 %	60 %

## BRAKES

Operation	Hydrostatic	Hydrostatic
Parking	Multi disc	Multi disc
Emergency	Multi disc	Multi disc

## VIBRATION

Amplitudes	2 / 1 mm	2 / 1 mm
Frequencies	29 / 35 Hz	29 / 35 Hz
Centrifugal forces	325 / 237 kN	325 / 237 kN

## TANKS

Fuel	410 lt	410 lt
------	--------	--------

## ELEKTROINSTALLATION

Voltage	24 V	24 V
Capacity of batteries	2x100 Ah	2x100 Ah

## ENGINE

Make	Cummins	Cummins
Type	QSB5.9-30-T-C155	QSB5.9-30-T-C155
Rated power	116 kW	116 kW
Standard	ISO 3046/1 (DIN 6271)	ISO 3046/1 (DIN 6271)

Technical modifications and data reserved. Machines may be shown with options.



**STAVOSTROJ, a.s.**

Náchodská 145, 549 01 Nové Město nad Metují, Czech Republic

phone: +420 491 476 111

fax: +420 491 470 215, 491 470 405

e-mail: stavo@sta.cz, stasales@sta.cz, www.sta.cz

CERTIFICATED:  
**ISO 9001**