



is a well-proved vibratory roller of high technical parameters. It features a unique steering undercarriage which provides the machine with very easy and proper control of the travel direction. Both the travel drive and the vibration drive systems are mechanical. Both drums are smooth, driven and fitted with scrapers. The one-stage directed vibration exciter is located on the machine frame. The machine is equipped with gravity watering system. Hatz engine. The machine meets the CE marking conditions.

## STANDARD

- Singlewheel bogie steering
- Safety crank handle
- Two smooth, propelled drums
- Vertically directed vibration
- Gravitation sprinkling system
- Two speed ranges (forward, reverse)
- Chock block

## MAXIMAL COMPACTED LIFT THICKNESS AT OPTIMAL WORKING CONDITIONS (m)

	Asphalt	Sand/Gravel	Mixed soils	Silt	Clay	Stabilization
<b>VVW 3415</b>	0,10 m	0,20 m	0,15 m	-	-	-



CERTIFICATED:  
**ISO 9001**

**STAVOSTROJ, a.s.**  
 Náchodská 145, 549 01 Nové Město nad Metují, Czech Republic  
 phone: +420 491 476 111  
 fax: +420 491 470 215, 491 470 405  
 e-mail: stavo@sta.cz, stasales@sta.cz, www.sta.cz

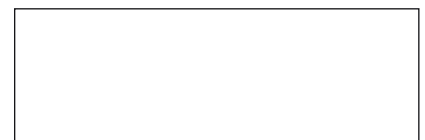



size (mm)	A	D	G	H	L	L1	T	W	W1	W2
VVW 3415	600	500	180	1125	2800	1400	8	750	930	27

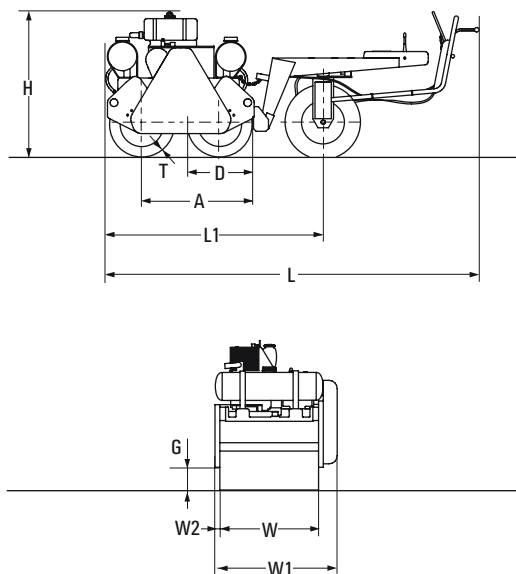

## CAPACITY

VVW 3415

Operating weight (CECE)	1160 kg
Compacting width maximum	750 mm

## WEIGHTS

Operating weight maximum	1190 kg
Front drum load (CECE)	535 kg
Rear drum load (CECE)	355 kg
Front drum linear load	7,13 kg/cm
Rear drum linear load	4,73 kg/cm

## STEERING

Turning radius inner (edge)	4500 mm
Turning radius outer (contour)	5410 mm
Transversal stability - straight	32 deg

## RIDING CHARACTERISTIC

No. of travel speeds	2
Maximal speed	3,4 km/h
Gradeability without vibration	45%
Gradeability with vibration	27%

## BRAKES

Operation	Engine
Parking	Multi disc
Emergency	Multi disc

## VIBRATION

Amplitudes	0,7 mm
Frequencies	50 Hz
Centrifugal forces	34 kN

## WATERING

Watering	Gravity
Water filtration stages	1

## TANKS

Fuel	4,8 lt
Watering water	56 lt

## ENGINE

Make	Hatz
Type	1D 41.S
Rated power	4,5 kW
Standard	ISO 3046/1 (DIN 6271)

Technical modifications and data reserved.  
Machines may be shown with options.

